

**Tuba Rest Accessory
on a Nota Standard Chair**

Contents

| | | | |
|--------------------------------------|---|-----------------------------|---|
| Important User Information | 2 | Supplied Hardware | 2 |
| Safety Precautions | 2 | Parts List | 3 |
| Required Tools | 2 | Assembly | 4 |



Visit the Nota Chairs web page at wengercorp.com for more information.

Note: Please read and understand these instructions before proceeding.
Note: If you need additional information, contact Wenger Corporation using the information below.

Important User Information

General

Copyright © 2024 by Wenger Corporation

All rights reserved. No part of the contents of this manual may be reproduced, copied, or transmitted in any form or by any means including graphic, electronic, or mechanical methods or photocopying, recording, or information storage and retrieval systems without the written permission of the publisher, unless it is for the purchaser's personal use.

Printed and bound in the United States of America.

The information in this manual is subject to change without notice and does not represent a commitment on the part of Wenger Corporation. Wenger Corporation does not assume any responsibility for any errors that may appear in these instructions.

In no event will Wenger Corporation be liable for technical or editorial omissions made herein, nor for direct, indirect, special, incidental, or consequential damages resulting from the use or defect of these instructions. The manufacturer reserves the right to change this product at any time.

The information in this document is not intended to cover all possible conditions and situations that might occur. The end user must exercise caution and common sense when assembling or installing Wenger Corporation products. If any questions or problems arise, call the Wenger Corporation at (800) 4WENGER (493-6437) or +1-507-455-4100 worldwide.

Manufacturer

The Tuba Rest Accessory is manufactured by:

Wenger Corporation
555 Park Drive
Owatonna, MN 55060
(800) 4WENGER (493-6437) • +1 (507) 455-4100
wengercorp.com

Intended Use

- This product is intended for indoor use in normal ambient temperature and humidity conditions – it must not be exposed to prolonged outside weather conditions.
- This product is intended to be assembled and used only as described in these instructions.

Warranty

Warranty information is available at wengercorp.com.

Safety Precautions

Throughout this document you may find cautions and warnings which are defined as follows:

- **WARNING:** Failure to follow the instruction could result in serious injury or damage to property.
- **CAUTION:** Failure to follow the instruction could result in minor injury or damage to property.

Read all of these safety instructions before using the equipment.

⚠ CAUTION

Make sure anyone assembling, installing or using this product has read and understands these instructions.

⚠ CAUTION

Failure to comply with Warnings and Cautions in this document or on the equipment can result in damage to property or injury.

Required Tools

- Electric drill with 1/2" socket or 1/2" socket wrench
- In-Lb torque wrench is recommended

Supplied Hardware

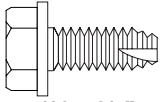

5/16 x 3/4"
Hex Head Self-tapping Screw

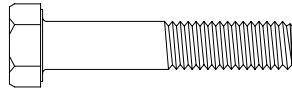

5/16-18 x 1-3/4"
Hex Head Capscrew

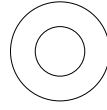

5/16" ID
Flat Washer

Parts List

| Item | Qty | Description |
|------|-----|---|
| 1 | 1 | Base Assembly |
| 2 | 1 | Rest Assembly |
| 3 | 4 | 5/16 x 3/4" Hex Head Self-tapping Screw |
| 4 | 2 | Adapter Bracket |
| 5 | 4 | 5/16-18 x 1-3/4" Hex Head Capscrew |
| 6 | 4 | 5/16" ID Flat Washer |

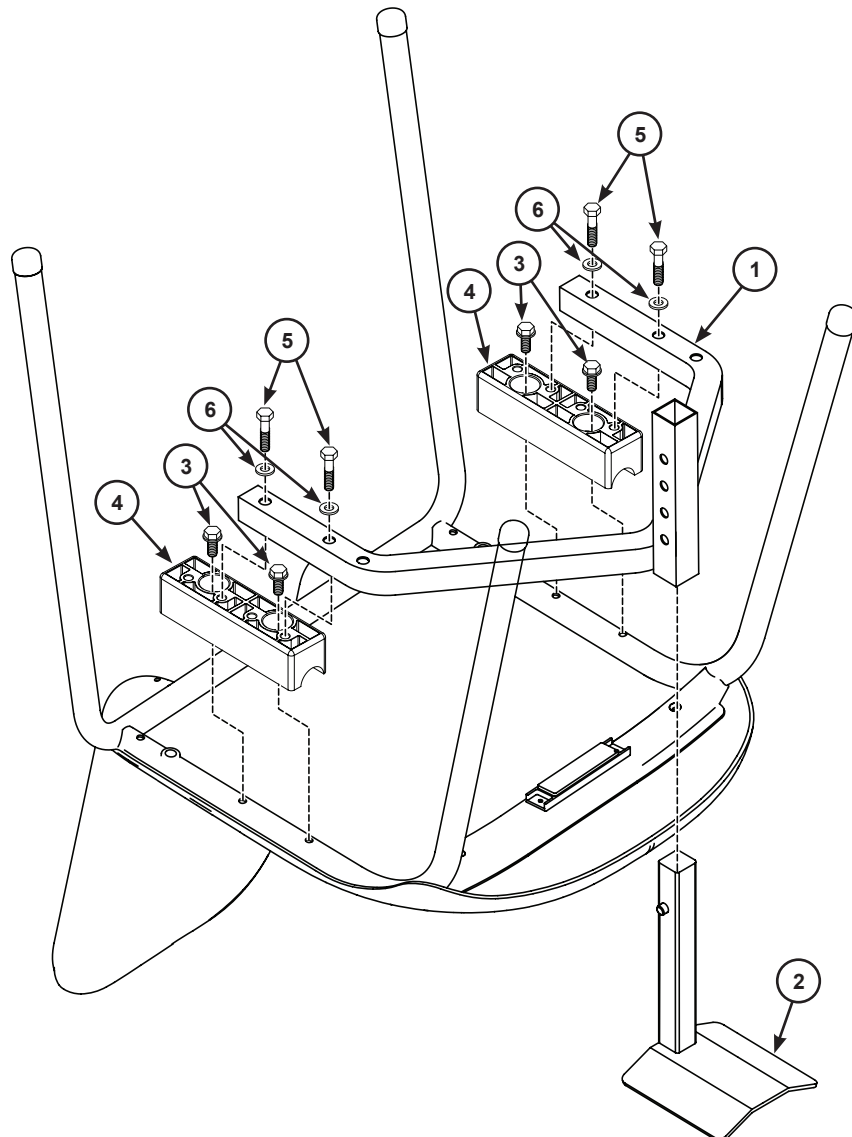

Assembly

1. Place the Nota chair upside down on a table, bench, or floor surface covered with a pad or blanket to protect the seat and back surfaces.

2. Pre-cut the adapter bracket mounting hole threads in the pre-punched holes of the chair frame using the 5/16 x 3/4" self-tapping screws.

This is easiest done with an electric drill fitted with a 1/2" socket, but can also be done with a socket wrench, although more difficult.

It is easier to obtain straight threads with an electric drill, which makes the mounting of the base assembly easier.

After cutting the threads, remove the self-tapping screws.

3. Orientate the four threaded holes of the adapter bracket towards the outside of the chair as marked on the bracket.

Attach both adapter brackets to the underside of the chair. Use the two 5/16 x 3/4" self-tapping screws in each bracket.

Make sure the four threaded holes of the adapter bracket are oriented towards the outside of the chair as marked on the adapter.

4. Press the snap button and remove the rest assembly from the base assembly.

Attach the base assembly to the adapter brackets using the middle and rear holes of the base assembly, and the first (front) and third threaded holes of each bracket.

a. Use four 5/16-18 x 11/4" cap screws and four 5/16 washers.

NOTICE

Make sure that the cap screws are hand started into the threaded holes of the adapter bracket before tightening with a wrench.

The base assembly may have to be moved around slightly to start all four of the cap screws in the threaded holes.

b. Tighten the cap screws with a wrench but do not exceed a tightening torque of 14 ft-lbs (170 in-lb). Over tightening the screws may damage the threads in the brackets.

The use of an in-lb torque wrench is highly recommended to prevent over-tightening of the screws.

5. Place the chair upright. Press the snap button and slide the rest assembly into the base.

Top plate of rest assembly can face forward (as shown) or backward.

To adjust height of rest assembly, position the snap button in the appropriate hole.

Bottom View of Adapter Bracket

